

WEIKAN™-V3



V3 – 1500

User Manual

User Manual:



1: Power

2: Volume +

3: Volume -

4: Mode A

5: Mode B



6



6: Snap joint

7: Plug

7

2

Installation instruction:



Find a proper location to fix the clamp



Install bluetooth interphone onto the clamp under instruction



The location of the installation of headphones and mic



Finished installation

How to use:

【 Power on 】 : At off stage, long press Power key for approx. 2s, V3 power on.

【 Power off 】 : At on stage, simultaneously press Power key and Volume '+' key for approx. 0.2s, V3 power off.

【 Clean up matching record 】 : To clean up matching record, simultaneously press A key and B key for approx. 0.2s until red light blinks, record cleaned up successfully.

Pair with cell phone:

【 Pair with cellphone 】 : in power off state, Press the power on key about 5–7 seconds, with red and blue light flash alternately, open the cellphone bluetooth function, when searching, see left photo, press connecting, pairing successful when red light flash off, blue light flash rhythmically.

【 Pair with second cell phone 】 : after pair with the first cell phone, turn off V3, and repeat pairing as first step, second cell phone pair successfully, then double press “+” key, V3 will repair with the first cell phone which stand by.

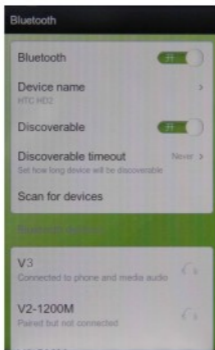

pair with bluetooth equipment instruction

Operating instructions:

【 Receive call 】 :

if there is phone call, after about 6S, will automatic answering calls.

【 Refused the call 】 :

if there is phone calls within 6 seconds, long press the Power button, after about 2S can decline a call.

【 Call hang up 】 :

during phone call, short press Power key, can end the phone call.

【 Voice dialing 】 :

In mobile phones and V3 connection standby mode, double click the volume "+" key, can enter the mobile phone voice dialing.

【 Replay the end code 】 :

In mobile phones and v3 connection standby mode, double click the volume "-" Key, can enter to replay the phone code.

【 The music play/pause 】 :

In mobile phones and V3 connection standby mode, short press Power key, can open the phone music playback mode, play songs. Short press Power key again, can stop the music played.

【 The music and song 】 :

After the mobile phone and the V3 connection, during music playing , double-click the "-" button, the volume can jump a song playing; Double-click the volume "+" button, can skip to the next play.

【 Volume 】 :

Short press the volume "+" key to increase volume;

Short press "-" volume to reduce the volume.

Paring instructions:

[Two V3 A mode pairing] :

Two V3 is on at the same time, Long press A key approx.3-5 seconds, red and blue lights flashing alternating ,then press either V3's A key, The machine the red light off, blue light flashing, at search matching state, After about 5 to 7 seconds, the other V3 red light off, blue lights flashing. pairing successfully. Short press again either V3' A Key, can enter intercom state. If you want to end intercom, short press either A Key to exit.

[Two V3 B mode pairing] :

Two V3 is on at the same time, Long press B key approx.3-5 seconds, red and blue lights flashing alternating ,then press either V3's B key, The machine the red light off, blue light flashing, at search matching state, After about 5 to 7 seconds, the other V3 red light off, blue lights flashing. pairing successfully. Short press again either V3' B Key, can enter intercom state. If you want to end intercom, short press either B Key to exit.

Three V3 two intercom model diagram:



【 V3 switching two intercom 】 :

Step 1: No.1 and No. 2 machine using A mode matching, only two people talk to each other.

Step 2: No.2 and No.3 machine B mode matching, only two people talk to each other.

Step 3: the No.1 and No.3 machine for BA pattern matching, only two people talk to each other.

Accessories:



USB charger
lead

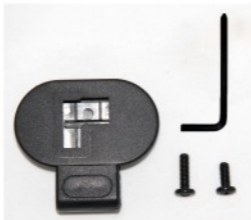

Clamp
connected and
installed unit



AC&USB
charger

Safety precautions:

1. During the riding, any changing the setting of this product, cellphone pairing operation is prohibited in order to avoid any traffic accidents.
2. If product is smoking, hot, odour, please cut off power supply immediately, and stop using it, So as not to cause an electric shock, fire and other accidents
3. Please do not put this product into the fire, the built-in battery has the possibility of an explosion.
4. Please do not do STH without authorization remove, modification of this product, maybe will lead to product defects, and get an electric shock, fire accidents, etc.

Abnormal case handling:

Because of the water inside the product, or fall, impact and other causes of casing damaged, and abnormal voice, smoke, odour, such as abnormal happens, please immediately cut off the power and stop using it.

It is strictly prohibited to disassembly and repair by customer.

Warning:

1. Avoid harmful behaviors of the products, such as drop and shock, otherwise it will cause malfunction.
2. Please do not put the product near the fire or direct sunlight for a long time.
3. Keep this product away from children.
4. Using this product within $-40\text{ }^{\circ}\text{C}$ to $60\text{ }^{\circ}\text{C}$ temperature environment, higher or lower than the temperature, will be no guarantee of normal using.
5. The company product accessories are verified by test, suggest use our verified accessories.

Note for charging:

1. Please use our company's accessories USB cable for charging, lest cause the occurrence of smoke, fire, and so on.
2. If long time of no using this product, at least one time charge behavior every year, lest can't open the machine and the damage to the battery.
3. When charging, please use the power adapter and at room temperature, please avoid recharged in near fire place, lest cause smoke, even fire.
4. In the process of charging, Odour, burning, etc., please immediately cut off the power and stop using it. In order to avoid the smoke and fire accidents.

WEIKAN™-V3



V3 - 1500

用户手册

功能介绍：



1.Power键

2.音量“+”

3.音量“-”

4.A模式键

5.B模式键



6



6.卡扣

7.充电/耳机 插头

7

如何正确安装本产品：



首先安装夹子于头盔上



按图中指示方向把V3扣在夹子的位置上



安装耳机和麦克风位置



安装之后的如上图

开关机操作：

【开机】：

关机的状态下，长按Power键约2秒后，V3开启。

【关机】：

开机的状态下，同时按Power键和Volume +键约0.2秒，V3关闭。

【清除配对记录】：清除配对记录，同时按下A键和B键约0.2秒，红灯闪烁，记录清除成功。

配对手机操作:

【配对手机】：

关机状态下，长按Power键约5秒后，直到红蓝灯交替闪烁，同步点击手机，打开蓝牙设备，搜索蓝牙列表中，选择“V3”设备，进行连接。V3红灯灭，蓝灯节奏闪烁时，配对成功。

【连接两个蓝牙设备操作】：

连接好第一个蓝牙手机，然后关闭V3，重新进行一次手机配对操作，连接第二个蓝牙手机。再双击一下音量“+”键，V3会重连第一个待机状态下的蓝牙手机。

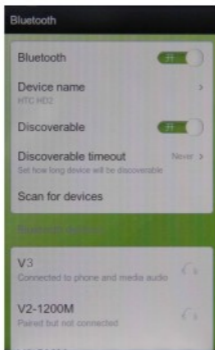

配对手机示意图

连接手机后操作指示：

【来电接听】：

手机来电约6秒后, V3自动接听来电。

【来电拒绝】：

手机来电后6秒内，未接听时，长按Power键约2秒后，可以拒接来电。

【通话挂断】：

在通话状态下，短按Power键，可以挂断电话，退出通话状态。

【语音拨号】：

在手机和v3连接待机状态，双击音量“+”键，可以进入到手机语音拨号状态。

【末码重播】：

在手机和v3连接待机状态，双击音量“-”键，可以进入到手机末码重播状态。

【音乐播放/暂停】：

在手机和v3连接待机状态，短按 Power键，可以打开手机音乐播放模式，播放歌曲。再次短按 power键，可以暂停音乐播放。

【音乐上下曲】：

在手机和V3连接后，音乐播放状态，双击音量“+”键，可以跳到下一曲播放；双击音量“-”键，可以跳到上一曲播放。

【音量调节】：

短按音量“+”键增大音量；
短按音量“-”键降低音量。

V3配对操作：

【两个V3的A模式配对】：

两个v3同时处于开机状态下，一起长按A模式键。3-5秒。进入红蓝灯交替闪烁状态，再按一下任一部v3的A模式键。该机红灯灭，蓝灯闪烁时启动即进入搜寻配对状态。约5-7秒后，另一部v3红灯灭，蓝灯进行闪烁状态。表示两机配对链接成功。再短按一下任一部A模式键，即可进入两机对讲通话状态。如要结束通话状态，再次短按A模式键即可退出。

【两个V3的B模式配对】：

两个V3同时处于开机状态下，一起长按B模式键。3-5秒。进入红蓝灯交替闪烁状态，再按一下任一部V3的B模式键。该机红灯灭，蓝灯闪烁时启动即进入搜寻配对状态。约5-7秒后，另一部v3红灯灭，蓝灯进行闪烁状态。表示两机配对链接成功。再短按一下任一部B模式键，即可进入两机对讲通话状态。如要结束通话状态，再次短按B模式键即可退出。

三个V3 两两对讲模式示意图：



【V3切换二人对讲】：

第一步：1号机和2号机使用A模式配对，仅此二人通话。

第二步：2号机和3号机进行B模式配对，仅此二人通话。

第三步：1号机和3号机进行BA模式配对，仅此二人通话。

包装配件情况:



USB充电线



卡座，
安装螺丝刀



AC&USB充电装

安全注意事项：

危险警示：

- 1.禁止在骑乘摩托车的期间，驾驶者进行本产品的设定进行变更、手机通话配对等操作，以免引起交通事故的发生。因骑乘过程中不正当操作使用本产品所发生的任何伤害，本公司概不负责，敬请谅解。
- 2.本产品发生冒烟，发烫，异臭等异常情况下，请立刻切断电源，并停止使用。以免引起触电、火灾等事故的发生
- 3.请勿将本产品投入火中，内置电池有发生爆炸的可能性。
- 4.请勿擅自拆卸，改装本产品，否则会照成产品缺损，以及触电，火灾等事故的发生。

异常情况下的处理：

因产品内部进水，或者跌落、冲击等原因引起的外壳破损，以及声音异常，冒烟，异臭等异常情况发生时，请马上切断电源，停止使用。
严禁客户自行拆卸及修理的行为。

注意：

- 1.避免跌落以及冲击等有害本产品的行为发生，否则会造成机器故障的发生。
- 2.请勿长时间将本产品放置在靠近明火或者阳光直射的地方。
- 3.远离儿童存放本产品。
- 4.本产品-40℃-60℃的温度环境中使用，超过此温度，将会无法保证产品正常的使用。
- 5.本公司产品所附配件均经过认证检验，如使用非本公司配件将可能影响产品的正常使用。

充电时注意事项：

- 1.请使用本公司的配件USB线进行充电，以免引起冒烟、起火等情况的发生。
- 2.如长时间不使用本产品时，至少本年进行一次充电行为，以免发生无法开启机器及损坏电池的情况发生。
- 3.充电时请使用电源适配器，并在常温下进行，请避免在近火处进行充电，以免引起冒烟，起火的情况发生。
- 4.充电过程中，发生异臭，发烫等情况，请马上切断电源，停止使用。以免冒烟及引起火灾等事故的发生。